

RoHS Compliant Customer Drawing

REV.	ECN NO.	DESCRIPTION	DATE	DESIGN

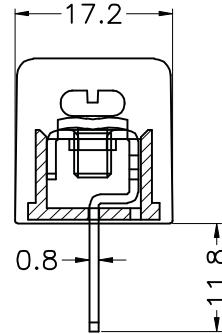
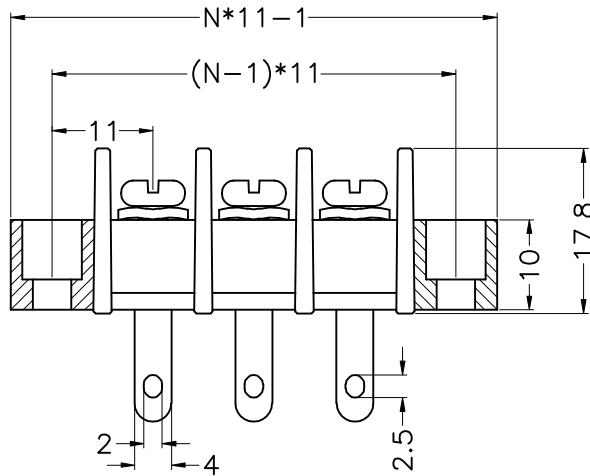
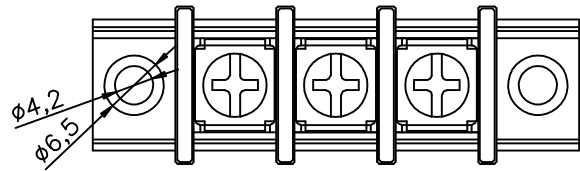

- 材质及电镀(Material)
 塑件(Housing): PA66, UL94V-0
 端子(Terminal): 黄铜, 1.0t 镀锡(Brass, Tin plated)
 螺丝(Screw): M4, 钢, 镀镍(Steel, Ni-Plated)
- 电气性能(Electrical)
 额定电压(Rated Voltage): 300V
 额定电流(Rated Current): 25A
 绝缘电阻(Insulation Resistance): 500MΩ/DC500V
 耐电压(Withstanding Voltage): AC2000V/Min
- 机械性能(Mechanical)
 温度范围(Temperature Range): -40℃~ +105℃
 适用线径(Wire Range): 22-14AWG
 最大扭矩值(Max. Torque Value): 0.5N.m 4.4Lb.in

订购方式/HOW TO ORDER

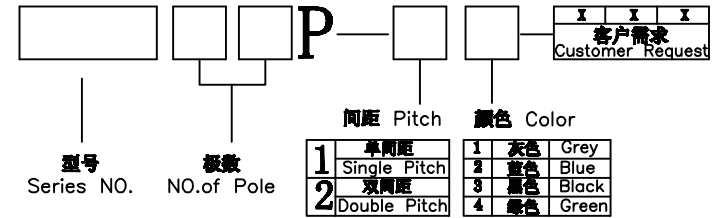

N=No. of contacts

Contact Us

TEL: +86 - 574 - 63510149 FAX: +86 - 574 - 63516735
 E-Mail: Sales@cxsuteng.com Website: www.cxsuteng.com

公差一览表				慈溪市速腾电子有限公司					
TOLERANCE UNLESS OTHERWISE				SUTOWN CIXI SUTENG ELECTRONIC CO., LTD					
X.	±0.25	X°	±5°	单位	mm	制图	No.01	产品名称	ST65H-11.0
.X	±0.20	.X°	±2°	角法	角法	设计	No.06	图号	
.XX	±0.15	.XX°	±1°	比例	1:1	审核		产品料号	ST65H-11.0
.XXX	±0.02	.XXX°	±0.5°	日期	2012.07.10	版本	A0	图号	ST65H-11.0
				DATE		APPD		DRAW NO.	